

| TOWN HWY. NO. | LENGTH IN MILES CLASS 3 | CLASS 4 | | |
|---------------|-------------------------|---------|--------------|---------------|
| 4 | 4.210 | (0.570) | 48 | 1.140 |
| 5 | 5.620 | | 50 | 0.320 |
| 6 | 3.080 | | 51 | 0.150 |
| 7 | 0.190 | | 52 | 0.660 |
| 8 | 2.550 | (0.160) | 53 | 1.580 |
| 9 | 0.220 | | 54 | 0.210 |
| 10 | 0.690 | | 55 | 0.160 |
| 11 | | (0.080) | 56 | 2.010 |
| 12 | 1.540 | | 57 | 0.790 |
| 15 | 1.070 | | 58 | 0.400 |
| 16 | 0.490 | | 59 | 0.300 |
| 18 | 4.540 | | 60 | 0.200 |
| 19 | 1.610 | (0.100) | 61 | 0.210 |
| 20 | 0.100 | | 62 | 0.470 |
| 22 | 5.330 | | 63 | |
| 23 | 3.400 | | 64 | 2.230 |
| 24 | 1.700 | | 65 | 0.080 |
| 26 | 0.200 | | 66 | 0.050 |
| 27 | 0.230 | | 67 | 0.090 |
| 28 | 0.840 | | 68 | 0.250 |
| 29 | 0.570 | | 69 | 0.070 |
| 30 | 1.100 | | 70 | 0.100 |
| 31 | 0.300 | | 72 | 0.060 |
| 32 | 0.170 | (0.390) | 73 | 0.270 |
| 33 | 1.730 | | 74 | 0.140 |
| 34 | 1.040 | | 76 | |
| 35 | 0.100 | | 77 | 0.120 |
| 37 | 0.260 | | 78 | 1.470 |
| 38 | 0.470 | | 79 | 0.040 |
| 39 | 0.200 | | 80 | 0.130 |
| 40 | 0.180 | | 81 | |
| 41 | 0.760 | | 82 | 0.090 |
| 42 | 0.250 | | 83 | 0.140 |
| 43 | 0.280 | | 84 | 0.100 |
| 44 | | (0.200) | 85 | 0.410 |
| 45 | 0.580 | (0.500) | 86 | 0.180 |
| 46 | 1.230 | | 89 | 0.530 |
| 47 | 0.200 | | TOTAL | 62.180 |
| | | | | 2.960 |

| MILEAGE SUMMARY | |
|-----------------------------------|---------------|
| CLASS 2 | |
| TH-1 | 2.520 |
| TH-2 | 6.050 |
| TH-3 | 1.120 |
| TH-4 | 4.030 |
| TOTAL CLASS 2 | 13.720 |
| CLASS 3 | |
| TOTAL CLASS 3 | 62.180 |
| TOTAL TOWN | 75.900 |
| STATE HIGHWAY | |
| VT-12 | 7.663 |
| TOTAL STATE HIGHWAY | 7.663 |
| STATE HIGHWAY - Ramp | |
| VT-12 | 0.042 |
| TOTAL STATE HIGHWAY - Ramp | 0.042 |
| US HIGHWAY | |
| US-4 | 0.773 |
| US-5 | 7.672 |
| TOTAL US HIGHWAY | 8.445 |
| TOTAL STATE | 16.150 |
| INTERSTATE | |
| I-91 | 7.629 |
| TOTAL INTERSTATE | 7.629 |
| INTERSTATE - Ramp | |
| I-91 | 0.901 |
| TOTAL INTERSTATE - Ramp | 0.901 |
| TOTAL INTERSTATE | 8.530 |

TOTAL, TRAVELED HIGHWAYS, FEB. 10, 2006: 100.580
(Excludes Class 4 Mileage)

- HIGHWAYS**
- INTERSTATE
 - U.S. ROUTE
 - STATE ROUTE
 - CLASS 1
 - CLASS 2
 - CLASS 3
 - CLASS 4
 - INTERSTATE OR DIVIDED HIGHWAY
 - STATE - HARD SURFACE OR PAVED
 - TOWN - HARD SURFACE OR PAVED
 - GRAVEL
 - SOIL OR GRADED AND DRAINED EARTH
 - UNIMPROVED OR PRIMITIVE
 - IMPASSABLE OR UNTRAVELED
 - LEGAL TRAIL
 - DISCONTINUED
 - HIGHWAY CLASS CHANGE
 - RAILROAD
- PUBLIC LAND**
- POLITICAL SUBDIVISIONS
 - STATE BOUNDARY
 - COUNTY BOUNDARY
 - TOWN BOUNDARY
 - VILLAGE BOUNDARY
 - URBAN COMPACT
- WATER BODIES**
- OPEN WATER
 - SWAMP
 - STREAM OR BROOK
- BRIDGE OR CULVERT**
- BRIDGE OR CULVERT GREATER THAN 20'
 - BRIDGE OR CULVERT 6' - 20'
 - B34 STATE BRIDGE IDENTIFIER
 - B34 TOWN BRIDGE IDENTIFIER
- FEDERAL CLASSIFICATION IDENTIFIER**
- FAU URBAN ARTERIAL OR COLLECTOR
 - MA MINOR ARTERIAL
 - MJC MAJOR COLLECTOR
 - MNC MINOR COLLECTOR
 - PA PRINCIPAL ARTERIAL

DISCLAIMER:
The untraveled highways (laid-out town highways), discontinued highways, and legal trails shown hereon are those of which the Agency of Transportation has record; others may exist.
Highway and bridge data by the Agency of Transportation, Policy & Planning Division. All other data from the Vermont Center for Geographic Information.

Vermont State Plane Coordinate System
North American Datum of 1983
SPCS_Zone_Identifier: 4400
Geodetic Reference System 80
4,000-meter grid, Easting - Northing

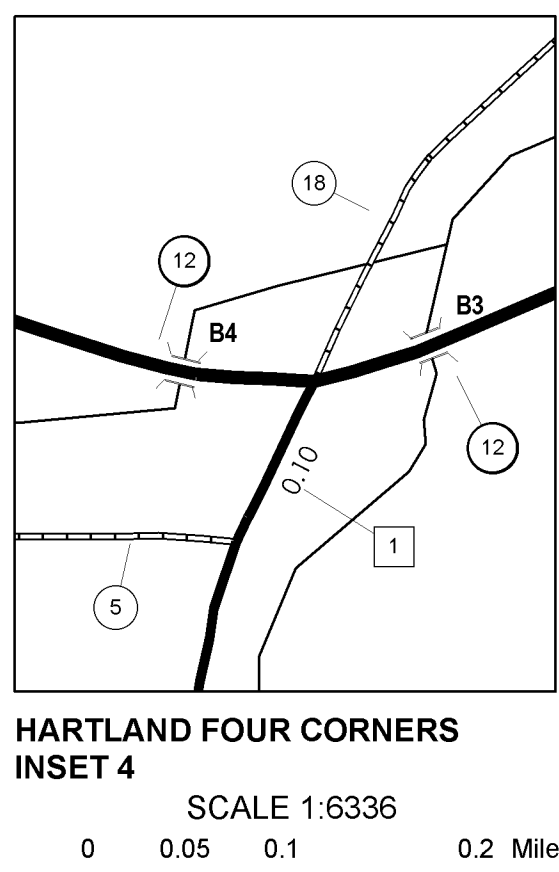
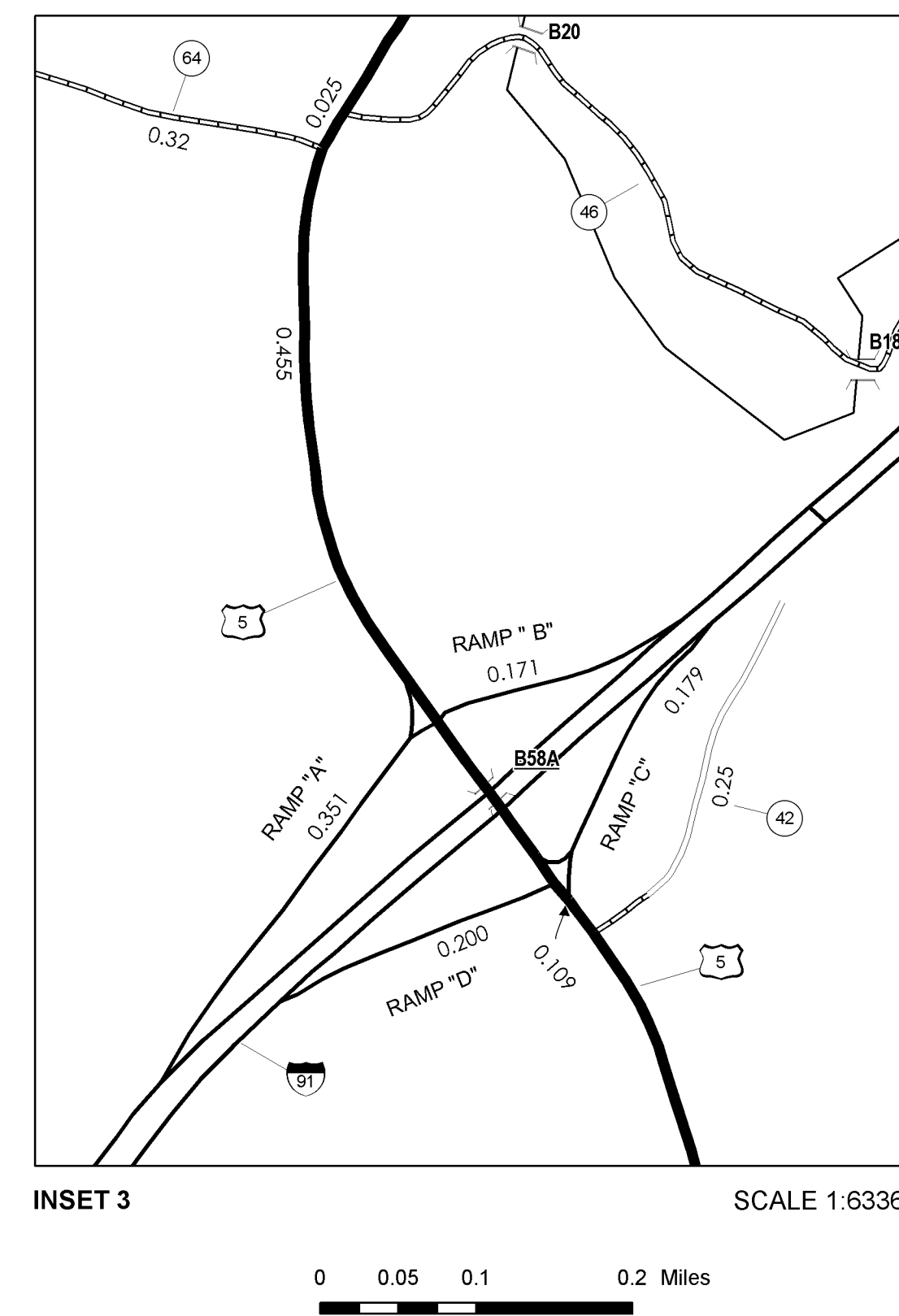
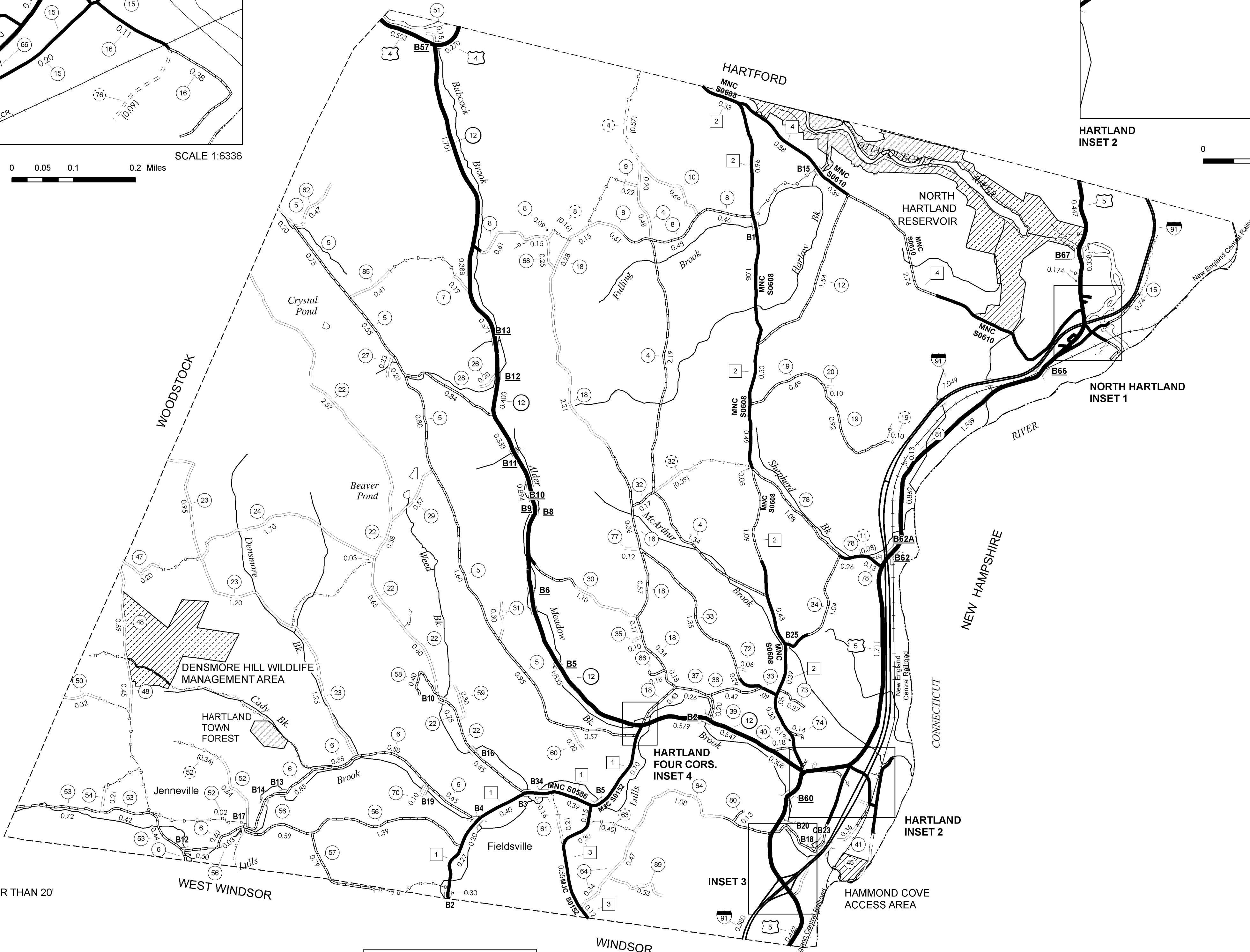
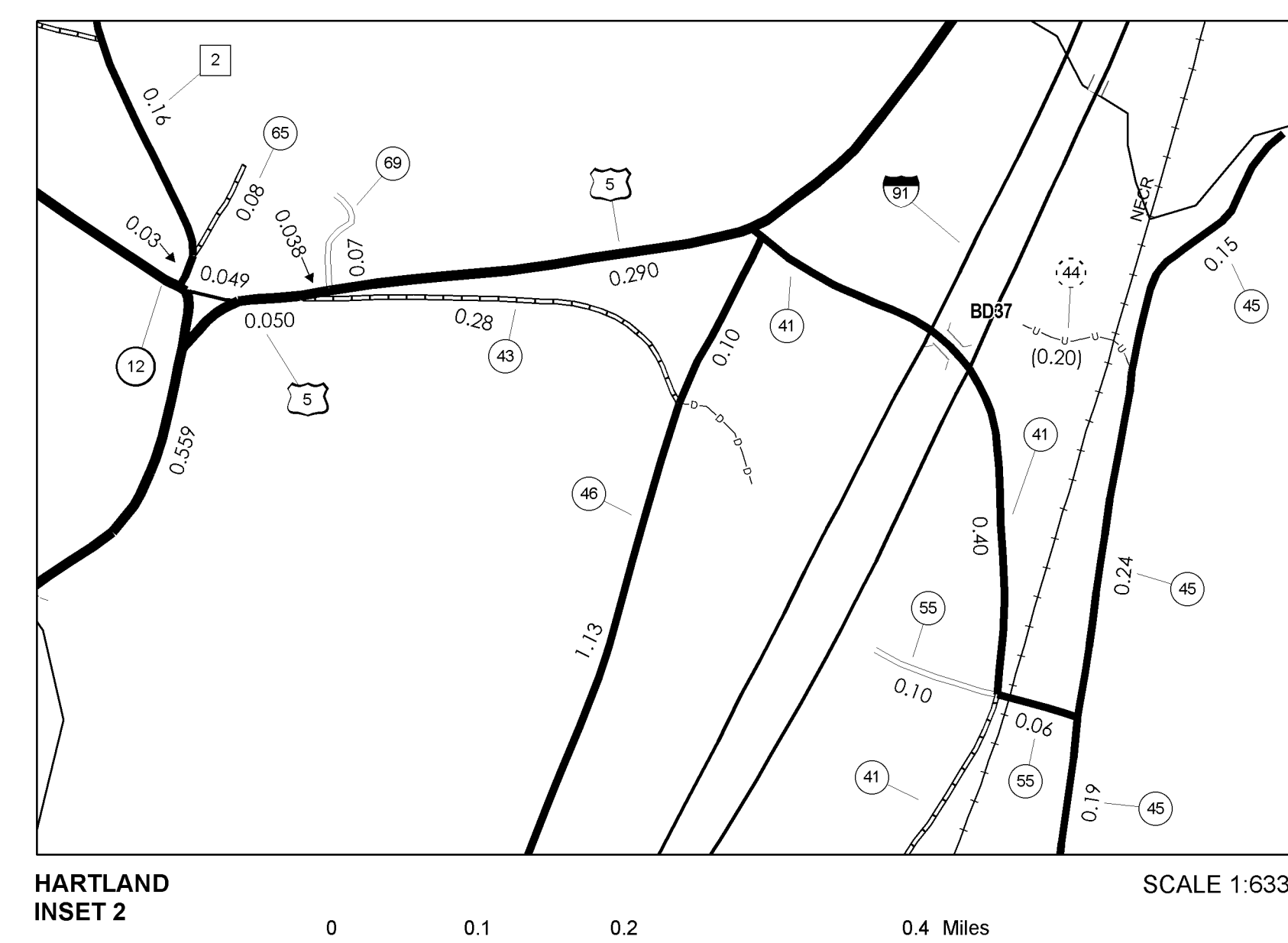
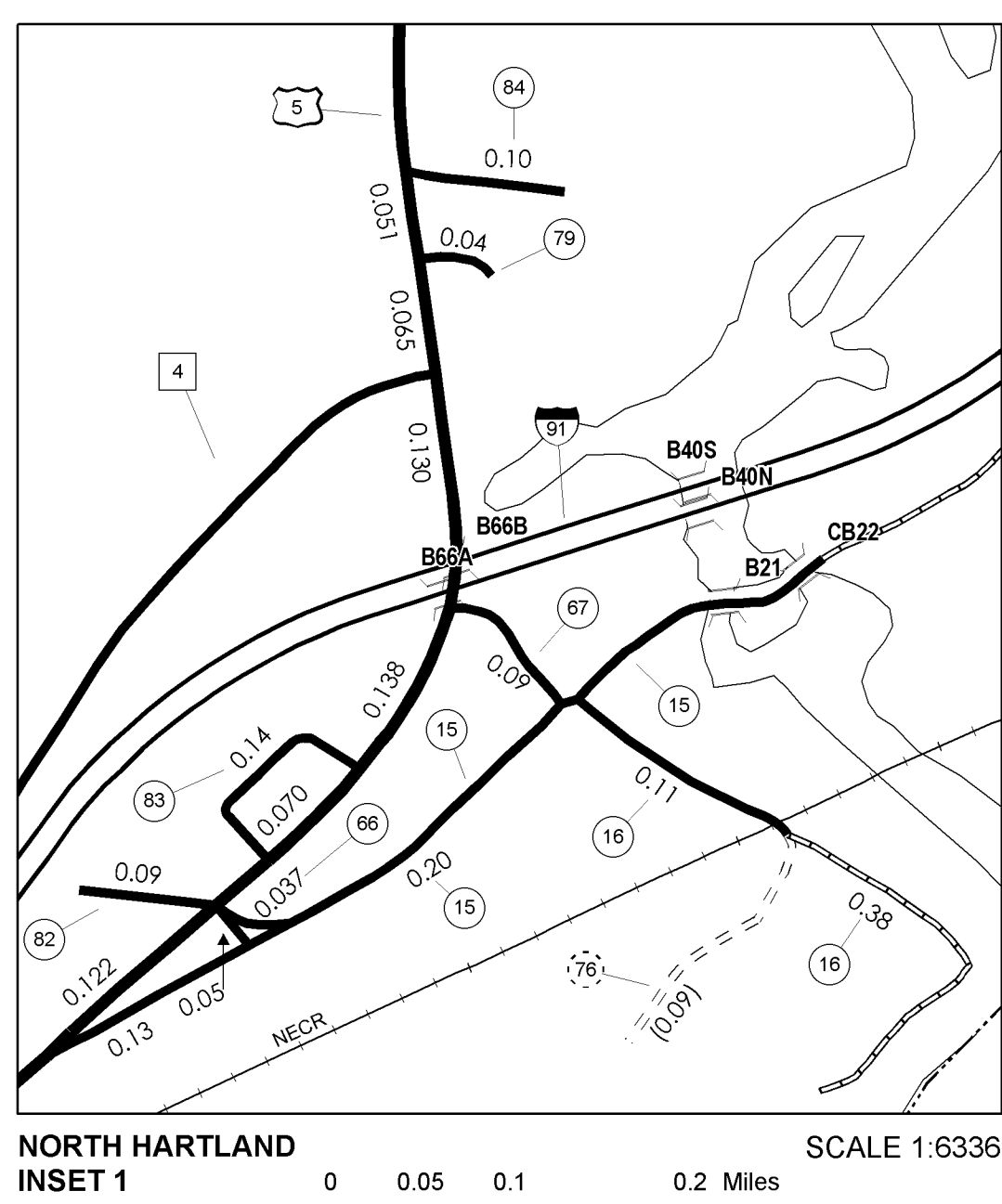

VERMONT GENERAL HIGHWAY MAP
Town of Hartland
WINDSOR COUNTY

Transportation District #4

Prepared by the
Vermont Agency of Transportation
Policy & Planning Division
in cooperation with
U.S. Department of Transportation
Federal Highway Administration

Mileage as of Feb. 10, 2006
Map generated: November, 2006

SCALE: 1:31680

